



### Nameplate Specifications

Output HP	<b>0.50 Hp</b>	Output KW	<b>0.37 kW</b>
Frequency	<b>60 Hz</b>	Voltage	<b>115 V</b>
Current	<b>9.3 A</b>	Speed	<b>1725 rpm</b>
Service Factor	<b>1.25</b>	Phase	<b>1</b>
Efficiency	<b>59.5 %</b>	Power Factor	<b>0</b>
Duty	<b>Continuous</b>	Insulation Class	<b>B</b>
KVA Code	<b>N</b>	Frame	<b>56</b>
Enclosure	<b>Drip Proof</b>	Thermal Protection	<b>N/R</b>
Ambient Temperature	<b>40 °C</b>	Drive End Bearing Size	<b>6203</b>
Opp Drive End Bearing Size	<b>6203</b>	UL	<b>Recognized</b>
CSA	<b>Yes</b>	CE	<b>N</b>
IP Code	<b>22</b>		

### Technical Specifications

Electrical Type	<b>Split Phase</b>	Starting Method	<b>SM</b>
Poles	<b>4</b>	Rotation	<b>Counterclockwise/Clockwise</b>
Mounting	<b>Resilient Base</b>	Motor Orientation	<b>ANY</b>
Drive End Bearing	<b>BALL</b>	Opp Drive End Bearing	<b>Ball</b>
Frame Material	<b>Rolled Steel</b>	Overall Length	<b>10.32 in</b>
Frame Length	<b>6.22 in</b>	Shaft Diameter	<b>0.630 in</b>
Shaft Extension	<b>1.88 in</b>	Thru-bolts Extension	<b>0 in</b>
Connection Drawing	<b>52A105377AA</b>	Outline Drawing	<b>52A101910P1</b>

This is an uncontrolled document once printed or downloaded and is subject to change without notice. Date Created:03/11/2020

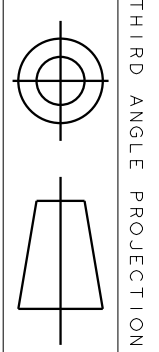

THIRD ANGLE PROJECTION

REVISIONS

REV.	DESCRIPTION	DATE	APPROVED
11	REDRAWN NO CHANGE T196-22390	07/10/96	MDP
12	CHG TO RBC FORMAT PER 1S05-1777	12/16/05	PRAVEEN.K

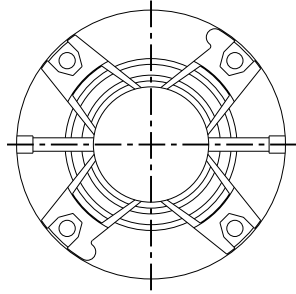

VIEW SHOWING PE VENTILATION OPENINGS

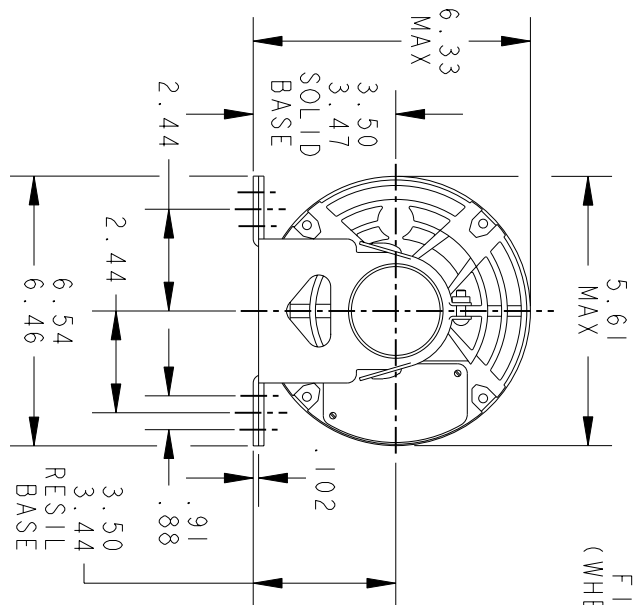

\*W IS A CLEARANCE DUE TO VARIATION IN PARTS & ASSEMBLY.

PT	TYPE	GE SIZE	NEMA FR	C	K	L	N	N-W	ZB
5	KH	35	56	9.89	1.38	3.80	1.88	2.01/1.79	.55/ .52
4	KH	39	56	11.85	1.38	5.76	1.88	2.01/1.79	.55/ .52
3	KH	37	56	10.72	1.38	4.63	1.88	2.01/1.79	.55/ .52
2	KH	38	56	11.32	1.38	5.23	1.88	2.01/1.79	.55/ .52
1	KH	36	56	10.32	1.38	4.23	1.88	2.01/1.79	.55/ .52



REGAL-BELOTT CORPORATION

TITLE OUTLINE

FORM N-GENERAL PURPOSE MOTOR-DRIP PROOF-SOLID OR RESIL BASE-BALL OR SLEEVE BEARING

SIGNATURES		DATE
MODEL	JPK	01/19/76
DETAIL		
CHECKED		
ENGRG		
MFG		
APPLIED PRACTICES	QUALITY	
DIMENSIONS ARE IN INCHES	ISSUED	MDP 07/10/96
MATERIAL	SOLID MODEL: 52A101910	

SCALE: 1.000	REF. No.:	
SIZE: DRAWING A		
52A101910	REV 12	SHEET 1 of 1

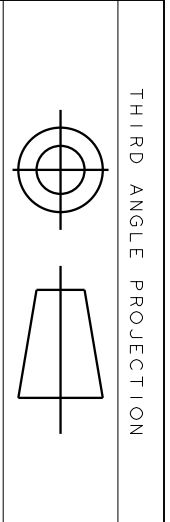

THIRD ANGLE PROJECTION

REVISIONS

REV.	DESCRIPTION	DATE	APPROVED
1	UPDATED FORMAT	11/10/05	MAM

EITHER ROTATION - SINGLE VOLTAGE  
TYPE KC, OR KH



NOTE #1 - TO REVERSE ROTATION INTERCHANGE BLACK (T5-KH OR J9-KC) AND RED (T8) LEADS.

NOTE #2 - WHEN MORE THAN ONE CAPACITOR IS USED CONNECT IN PARALLEL.

REF. DIAG. - 121A850		SWITCH (C) - 115D958AB	
CONNECTION LABEL - 52X332047			
SIGNATURES			
MODEL	M.D. PAPER	DATE	
DETAIL			
CHECKED			
ENGRG			
MFG			
QUALITY			
ISSUED	M.D.P.	DATE	
SOLID MODEL: 52A105377AA			
TITLE		REGAL-BELOIT CORPORATION	
FME: 30 FRAME SWITCH REDESIGN		CONNECTION DIAGRAM	
SIZE	DRAWING	SCALE	REF. No.
A		1.000	
MATERIAL		SCALE: 1.000	REF. No.:
FOR ADDITIONAL INFO REFER TO:		SHEET 1 of 1	
APPLIED PRACTICES			
DIMENSIONS ARE IN INCHES			